

SPECS

Custom drawn 4130 CrMo tubes
integrated 24mm spindle made of 4130 CrMo steel
SRAM 3-bolt direct mount made of 4130 CrMo steel
all other parts made of 7075T6 Aluminum
wave spring made of stainless steel
465g incl. all hardware

Chainline SRAM Ring 6mm Offset: 45mm
Chainline Spider outer Ring: 54mm
Chainline Spider inner Ring: 47mm

Made in Germany

LENGTH	
FINISH	
SERIAL	

WARRANTY

The **CYBER CRANKS** have been successfully tested by an independent test laboratory for road, XC and gravel use with a maximum rider weight of 110 kg. Downhill or BMX use is not recommended. The product comes with a 2-year warranty for the original purchaser. The warranty does not cover improper assembly, improper use or accidents.

CYBER CYCLES

07743 Jena
Germany

www.cybercycles.de
christian@cybercycles.de

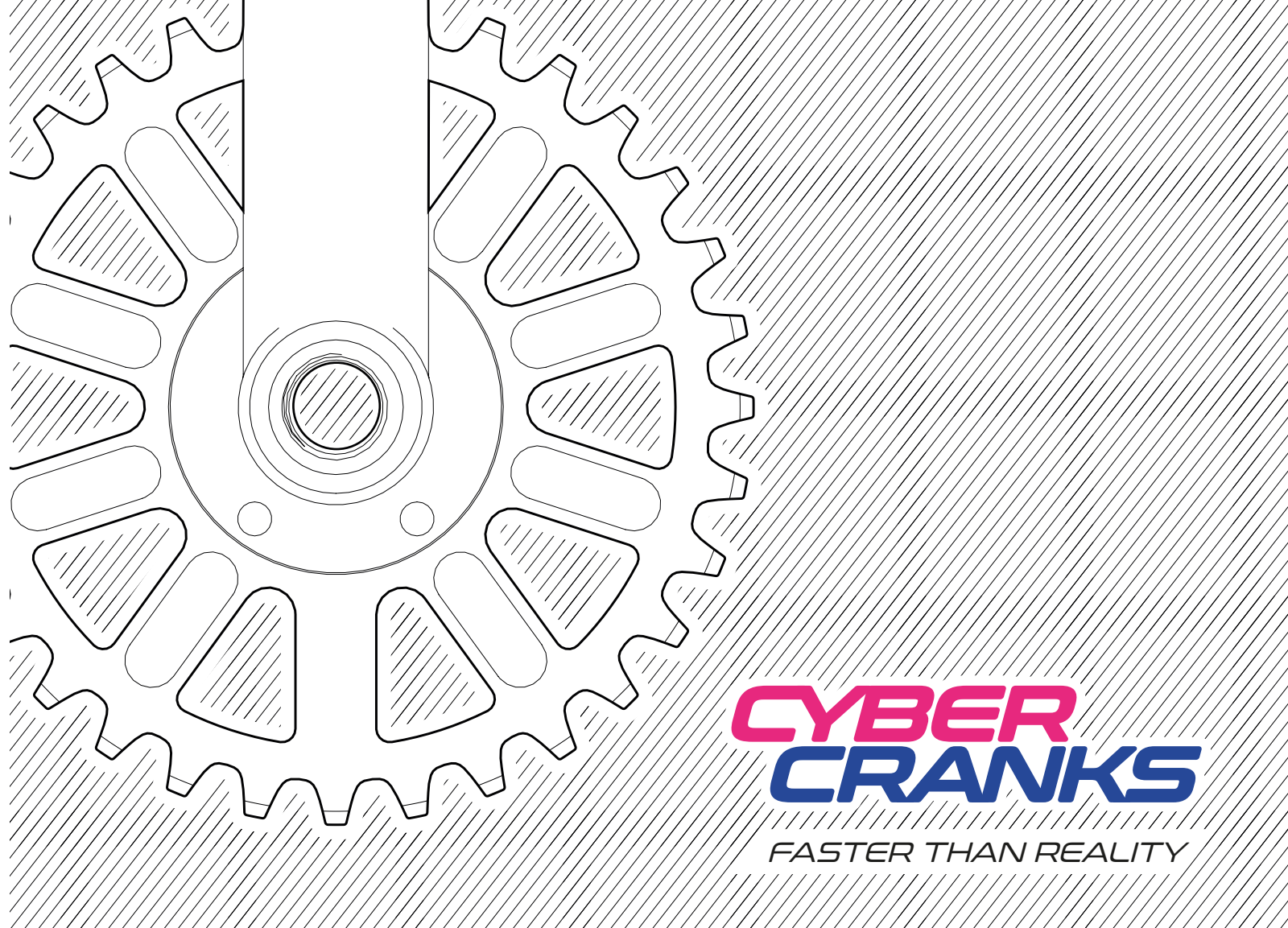

**CYBER
CRANKS**

FASTER THAN REALITY

INTRODUCTION

Thank you for purchasing the **CYBER CRANKS**. With your choice, you have not only revealed your penchant for unique solutions, but also enabled the launch of a new brand. This will enable us to continue to develop innovative and sustainable products in the future and implement them with perfect craftsmanship.

Stefano & Christian

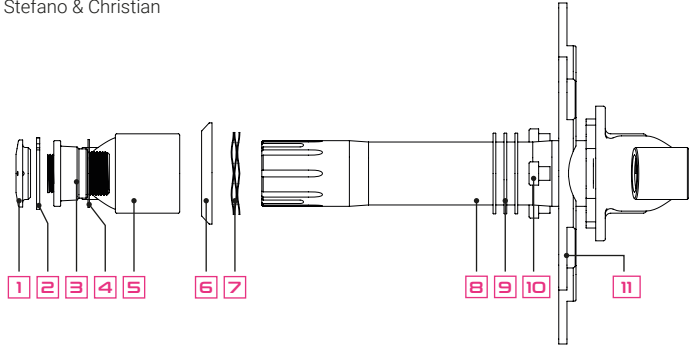

1 Cap	5 Crankarm Left	9 Spacer (3x)
2 Retention Clip	6 Compression Ring	10 Chaining Bolt
3 Crankarm Bolt	7 Wave Spring	11 Spider (optional)
4 Washer	8 Crankarm Right	

BOTTOM BRACKETS

The **CYBER CRANKS** are designed for use with 24mm (Hollowtech 2) bottom brackets and fit all bottom brackets with a shell width of max. 11.2mm and a housing width of 73mm. The following bottom brackets were measured:

bottom bracket	Shimano BBR60	Shimano MT800	Shimano BB93	Race Face Team	Hope Stainless	Praxis MTB	Chris King Threadfit
cup width	11.4mm	10.3mm	10.4mm	10.6mm	10.4mm	10.3mm	10.4mm
68mm	(yes)	yes	yes	yes	yes	yes	yes
73mm	-	yes	yes	yes	yes	yes	yes

ASSEMBLY INSTRUCTIONS

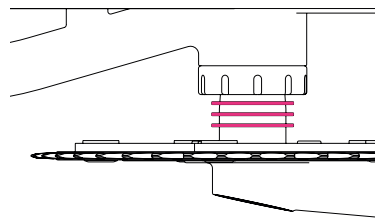
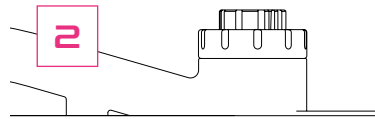
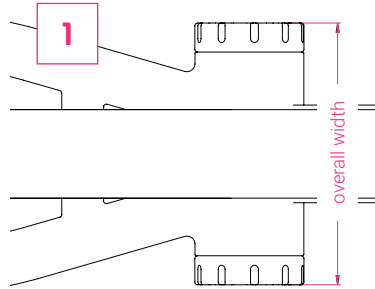

First, install the bottom bracket according to the manufacturer's instructions. Then measure the width of the installed bottom bracket. The width must be between 92.5 - 95.5mm. For 68mm wide frames, a spacer of 2.5mm should be used between the frame and the bottom bracket shell.

It is important that you use the supplied spacers to preload the bearings correctly. A different number of spacers is provided depending on the width.

overall width	number of spacer
95.5 - 94.5mm	1
94.5 - 93.5mm	2
93.5 - 92.5mm	3

Slide 1, 2 or 3 spacers onto the shaft of the **CYBER CRANKS** and insert the shaft through the bottom bracket. Depending on the chain line, the spacers can be positioned on the right or left.

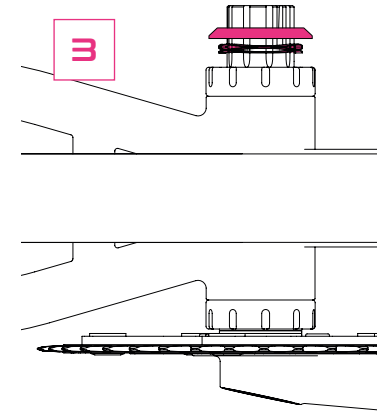

The wave spring and the compression ring must now be pushed onto the shaft.

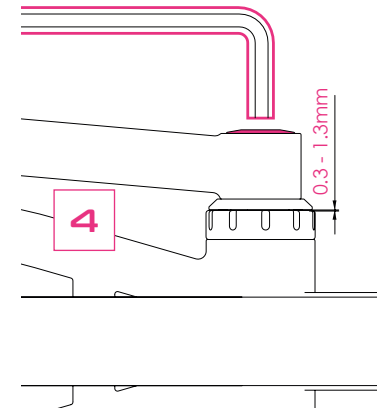

Finally, the left-hand crank including the screw is fitted onto the shaft. The fastening screw must be tightened with an 8mm hexagon socket and 25 Nm. After tightening the screw, a gap of between 0.3 - 1.3 mm should be visible. It is recommended to secure the screw with a medium-strength thread-locker (e.g. Loctite 243).

If you have not used locking varnish, you should check the crank bolt again after approx. 50 km and tighten it if necessary.